

# NEOZED D0 fuse-links aM 400/440VAC

LOW VOLTAGE IEC FUSES

DIN LV FUSE-LINKS D0



The D0 fuse-system is installed in motor circuit protection, where fuse-links are accessible to non trained persons and can also be replaced by them.

The system is the most modern of the screw systems and designed for 400VAC/440VAC networks.

Type “aM” fuse-links are partial-range breaking capacity fuse-links, used to protect motor circuits as they are strongly current-limiting and have low power losses.

They limit and cut off short circuit currents from 6.3 times  $I_n$  up to their nominal breaking capacity.

## TECHNICAL DATA OVERVIEW

Voltage Range AC	400 ... 440 VAC
Ampere Range (A)	20 ... 35 A
Speed/Characteristic	aM
I.R. AC (IEC)	100 kA
Product Size	D02

## FEATURES & BENEFITS

- Insulated body suitable for high mechanical and thermal impacts
- Top and bottom contacts made of nickel plated or silver plated copper alloy
- Safe cut-off short circuits due to special design of fuse element
- Clear indication of operation condition due to coloured indicator on top contact
- Low power dissipation
- Optimized size
- Resistant to aging

## APPLICATIONS

- Motor circuit protection

## STANDARDS

- DIN VDE 0636-3



# NEOZED D0 fuse-links aM 400/440VAC

## PRODUCT RANGE

### Size D02 (E18) aM



D02AM44V25

Catalog number	Item number	Rated voltage AC (IEC)	Rated current I <sub>n</sub>	Colour	Power dissipation at I <sub>n</sub>	Utilisation category	Package	Weight
D02AM44V20	H211607	440 V	20 A	blue	2.5 W	aM	10	13.2 g
D02AM44V25	F212640	440 V	25 A	yellow	3 W	aM	10	13.2 g
D02AM44V35	J213655	440 V	35 A	black	4 W	aM	10	13.2 g

# NEOZED D0 fuse-links aM 400/440VAC

## TIME CURRENT CHARACTERISTIC CURVES

NEOZED D0 fuse-links aM 400/440VAC

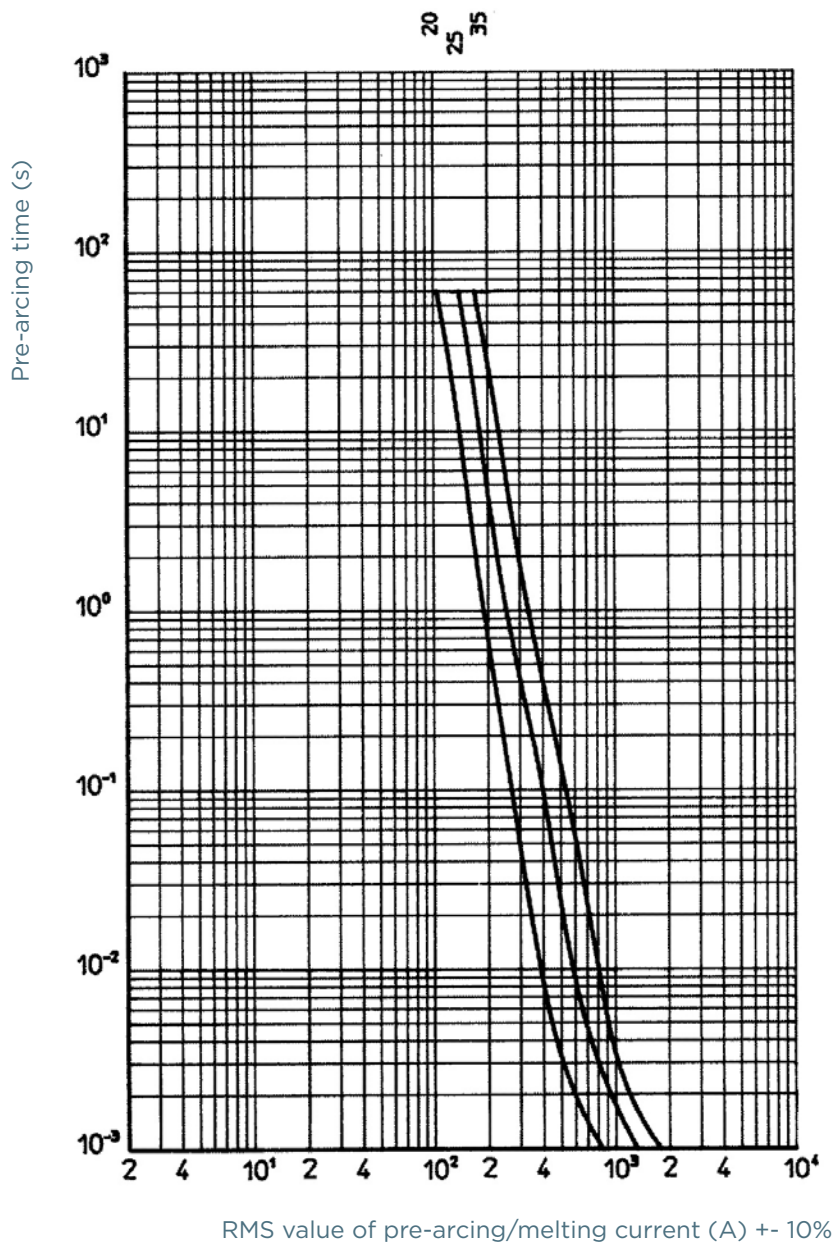

MERSEN reserves the right to change, update or correct, without notice, any information contained in this datasheet.

# NEOZED D0 fuse-links aM 400/440VAC

## CUT-OFF CURRENT CHARACTERISTIC

NEOZED D0 fuse-links aM 400/440VAC

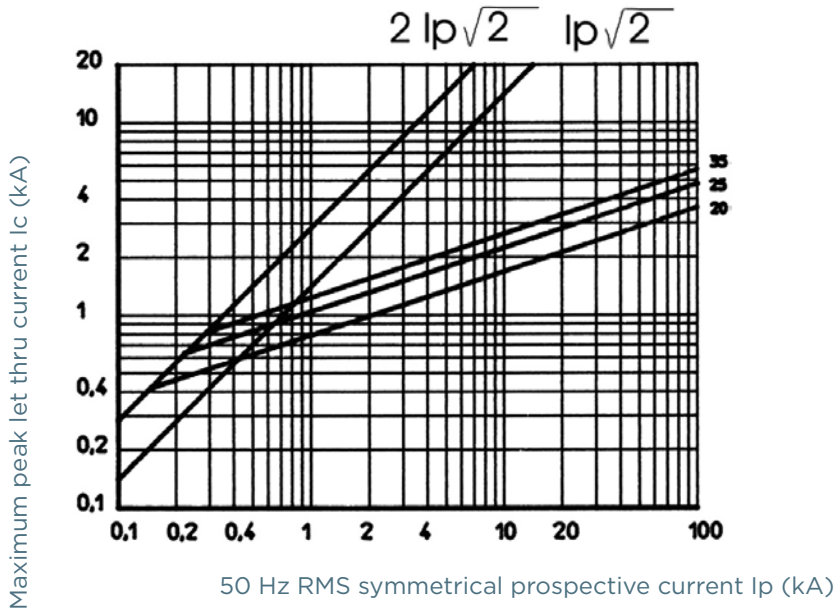

## DIMENSIONS

### NEOZED Fuse-Links

Size	a	b
D02	36 mm	15 mm

Dimensions in mm

### NEOZED Screw Caps

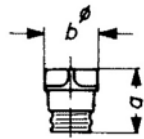

Article Number	a	b
01714.000000	29,5	23
01715.000000	29,5	23
01710.000000	31	25
01711.000000	31	25
01712.000000	37	40

Dimensions in mm

### NEOZED Adapter Inserts

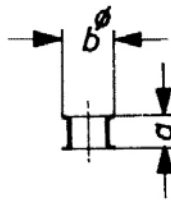

Article Number	a	b
01705.000000	10	12
01706.000000	10	16
01707.000000	10	27

Dimensions in mm

# NEOZED D0 fuse-links aM 400/440VAC

## ACCESSORIES



01715.000000



01711.000200

### Screw caps

Catalog number	Item number	Features	Package	Weight
<b>D0 screw caps 400VAC synthetic</b>				
01715.000200	P211981	D02, E18, 63A, with testing hole	20	11.6 g
11715.000220	S214537	D02, E18, 63A, with sealing and testing hole	20	11.6 g
01715.000000	L206435	D02, E18, 63A, without testing hole	20	12 g
<b>D0 screw caps 400/440 VAC, 250 V DC porcelain, with removal grips</b>				
01711.000200	T215044	D02, E18, 63A, with testing hole	20	18.5 g

### D0 cartridge ring adapter inserts D02 E18



01706.020000

Catalog number	Item number	Application	Features	Package	Weight
01706.020000	S200668	For D02 fuse links	20A, blue	50	0.5 g
01706.025000	R213524	For D02 fuse links	25A, yellow	50	0.6 g
01706.035000	J216070	For D02 fuse links	35A, black	50	0.5 g

### Locking devices



01715.810000

Catalog number	Item number	Design	Features	Package	Weight
01715.810000	Y215094	-	Locking cap for D02 E18 fuse-bases	5	13.7 g
01715.800000	R214582	-	Locking cap for D02 E18 fuse-bases for authorized personal only (EVU)	5	14 g

### Adapter inserts

Catalog number	Item number	Features	Package	Weight
01709.000000	P214028	Adapter for Size D02 fuse-links in Size D03 bases	25	1.3 g

MERSEN reserves the right to change, update or correct, without notice, any information contained in this datasheet.